

# ASSEMBLY INSTRUCTIONS

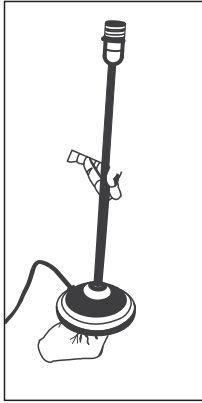

Fix the metal tube to the bottom of the base using a butterfly nut

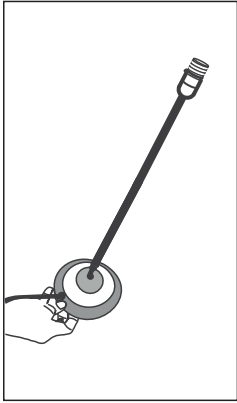
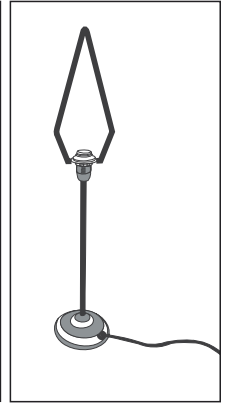
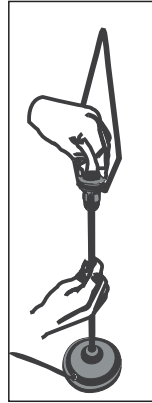
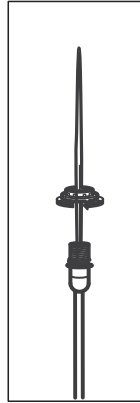
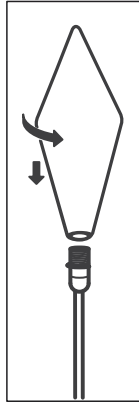

Place and fix the metal frame between the two rings on the lamp holder

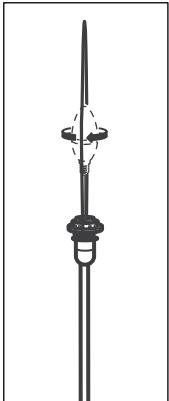

Place the light bulb (E14 socket) in the lamp holder

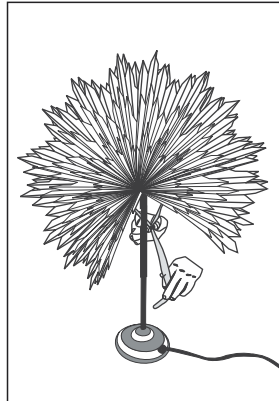
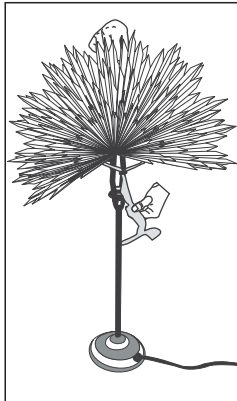

Assemble the Paper Star on the light stand and close the sides around the cord. Tie the string around the cord and lamp stand keeping the star close around the metal tube

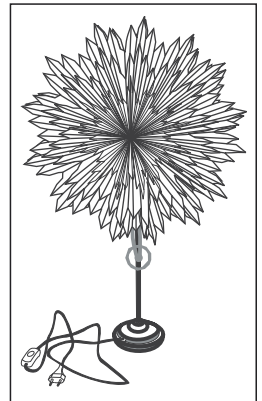

Connect the switch to the wall socket and Standing Star is ready to use